

CHROM ALU 200 ML- 800675 - A16245



SAFETY DATA SHEET

(REACH regulation (EC) n° 1907/2006 - n° 2015/830)

SECTION 1 : IDENTIFICATION OF THE SUBSTANCE/MIXTURE AND OF THE COMPANY/UNDERTAKING

1.1. Product identifier

Product name : CHROM ALU 200 ML- 800675

Product code : A16245.

1.2. Relevant identified uses of the substance or mixture and uses advised against

N/A

1.3. Details of the supplier of the safety data sheet

Registered company name : IPONE.

Address : La Meunière .13480.CABRIES .FRANCE.

Telephone : +33 (0)4 42 94 05 65. Fax : +33 (0)4 42 94 05 66.

info@ipone.fr

1.4. Emergency telephone number : +33 (0)1 45 42 59 59.

Association/Organisation : INRS / ORFILA <http://www.centres-antipoison.net>.

>SECTION 2 : HAZARDS IDENTIFICATION

2.1. Classification of the substance or mixture

In compliance with EC regulation No. 1272/2008 and its amendments.

Flammable liquid, Category 3 (Flam. Liq. 3, H226).

Skin irritation, Category 2 (Skin Irrit. 2, H315).

Eye irritation, Category 2 (Eye Irrit. 2, H319).

Specific target organ toxicity (single exposure), Category 3 (STOT SE 3, H336).

This mixture does not present an environmental hazard. No known or foreseeable environmental damage under standard conditions of use.

2.2. Label elements

> In compliance with EC regulation No. 1272/2008 and its amendments.

Hazard pictograms :



GHS07



GHS02

Signal Word :

WARNING

Product identifiers :

EC 919-857-5

HYDROCARBONS, C9-C11, N-ALKANES, ISOALKANES, CYCLICS, <2% AROMATICS

Hazard statements :

H226

Flammable liquid and vapour.

H315

Causes skin irritation.

H319

Causes serious eye irritation.

H336

May cause drowsiness or dizziness.

Precautionary statements - General :

P101

If medical advice is needed, have product container or label at hand.

P102

Keep out of reach of children.

P103

Read label before use.

Precautionary statements - Prevention :

P210

Keep away from heat, hot surfaces, sparks, open flames and other ignition sources. No smoking.

P261

Avoid breathing vapours.

P271

Use only outdoors or in a well-ventilated area.

P280

Wear protective gloves/protective clothing/eye protection/face protection.

Precautionary statements - Response :

P302 + P352

IF ON SKIN: Wash with plenty of water/...

CHROM ALU 200 ML- 800675 - A16245

P305 + P351 + P338 IF IN EYES: Rinse cautiously with water for several minutes. Remove contact lenses, if present and easy to do. Continue rinsing.
P312 Call a POISON CENTER/doctor/.../if you feel unwell.
Precautionary statements - Disposal :
P501 Dispose of contents/container according to the local rules.
Other information :
Do not use for a usage other one than the one for wich the product is intended.

> 2.3. Other hazards

REACH SVHC < 0.1%

Considering the information communicated by our suppliers, according to the article 33 of the REACH, the mixture contains, in the date of revision of the FDS, less than 0.1 % m/m of ' Substances extrêmement worrisome ' (SVHC) published by the European Agency of Chemicals (ECHA) according to the article 57 of the REACH: <http://echa.europa.eu/fr/candidate-liste-table>

SECTION 3 : COMPOSITION/INFORMATION ON INGREDIENTS

3.2. Mixtures

Composition :

Identification	(EC) 1272/2008	Note	%
INDEX: 919_857_5 EC: 919-857-5 REACH: 01-2119463258-33 HYDROCARBONS, C9-C11, N-ALKANES, ISOALKANES, CYCLICS, <2% AROMATICS	GHS07, GHS08, GHS02 Dgr Flam. Liq. 3, H226 Asp. Tox. 1, H304 STOT SE 3, H336 EUH:066		50 <= x % < 100
INDEX: 1344_28_1 CAS: 1344-28-1 EC: 215-691-6 REACH: 01-2119529248-35 ALUMINIUM OXIDE		[1]	10 <= x % < 25
INDEX: 007_001_01_2 CAS: 1336-21-6 EC: 215-647-6 REACH: 01-2119488876-14 AMMONIA SOLUTION	GHS05, GHS07 Dgr Skin Corr. 1B, H314 STOT SE 3, H335	B	1 <= x % < 2.5

Information on ingredients :

[1] Substance for which maximum workplace exposure limits are available.

SECTION 4 : FIRST AID MEASURES

As a general rule, in case of doubt or if symptoms persist, always call a doctor.
NEVER induce swallowing by an unconscious person.

4.1. Description of first aid measures

In the event of exposure by inhalation :

In the event of massive inhalation, remove the person exposed to fresh air. Keep warm and at rest.
If the person is unconscious, place in recovery position. Notify a doctor in all events, to ascertain whether observation and supportive hospital care will be necessary.
If breathing is irregular or has stopped, effect mouth-to-mouth resuscitation and call a doctor.

In the event of splashes or contact with eyes :

Wash thoroughly with fresh, clean water for 15 minutes holding the eyelids open.
If there is any redness, pain or visual impairment, consult an ophthalmologist.

In the event of splashes or contact with skin :

Remove contaminated clothing and wash the skin thoroughly with soap and water or a recognised cleaner.
Watch out for any remaining product between skin and clothing, watches, shoes, etc.
If the contaminated area is widespread and/or there is damage to the skin, a doctor must be consulted or the patient transferred to hospital.
DO NOT use solvents or thinners.

In the event of swallowing :

Do not give the patient anything orally.
In the event of swallowing, if the quantity is small (no more than one mouthful), rinse the mouth with water and consult a doctor.

CHROM ALU 200 ML- 800675 - A16245

Keep the person exposed at rest. Do not force vomiting.

Seek medical attention immediately, showing the label.

If swallowed accidentally, call a doctor to ascertain whether observation and hospital care will be necessary. Show the label.

4.2. Most important symptoms and effects, both acute and delayed

No data available.

4.3. Indication of any immediate medical attention and special treatment needed

No data available.

SECTION 5 : FIREFIGHTING MEASURES

Flammable.

Chemical powders, carbon dioxide and other extinguishing gas are suitable for small fires.

5.1. Extinguishing media

Keep packages near the fire cool, to prevent pressurised containers from bursting.

Suitable methods of extinction

In the event of a fire, use :

- sprayed water or water mist
- water with AFFF (Aqueous Film Forming Foam) additive
- halon
- foam
- multipurpose ABC powder
- BC powder
- carbon dioxide (CO₂)

Prevent the effluent of fire-fighting measures from entering drains or waterways.

Unsuitable methods of extinction

In the event of a fire, do not use :

- water jet

5.2. Special hazards arising from the substance or mixture

A fire will often produce a thick black smoke. Exposure to decomposition products may be hazardous to health.

Do not breathe in smoke.

In the event of a fire, the following may be formed :

- carbon monoxide (CO)
- carbon dioxide (CO₂)

5.3. Advice for firefighters

Due to the toxicity of the gas emitted on thermal decomposition of the products, fire-fighting personnel are to be equipped with autonomous insulating breathing apparatus.

SECTION 6 : ACCIDENTAL RELEASE MEASURES

6.1. Personal precautions, protective equipment and emergency procedures

Consult the safety measures listed under headings 7 and 8.

For non first aid worker

Because of the organic solvents contained in the mixture, eliminate sources of ignition and ventilate the area.

Avoid inhaling the vapors.

Avoid any contact with the skin and eyes.

If a large quantity has been spilt, evacuate all personnel and only allow intervention by trained operators equipped with safety apparatus.

For first aid worker

First aid workers will be equipped with suitable personal protective equipment (See section 8).

6.2. Environmental precautions

Contain and control the leaks or spills with non-combustible absorbent materials such as sand, earth, vermiculite, diatomaceous earth in drums for waste disposal.

Prevent any material from entering drains or waterways.

6.3. Methods and material for containment and cleaning up

If the ground is contaminated, once the product has been recovered by sponging with an inert and non-combustible absorbent material, wash the contaminated area in plenty of water.

Clean preferably with a detergent, do not use solvents.

CHROM ALU 200 ML- 800675 - A16245

6.4. Reference to other sections

No data available.

SECTION 7 : HANDLING AND STORAGE

Requirements relating to storage premises apply to all facilities where the mixture is handled.

7.1. Precautions for safe handling

- Always wash hands after handling.
- Remove and wash contaminated clothing before re-using.
- Ensure that there is adequate ventilation, especially in confined areas.

Fire prevention :

- Handle in well-ventilated areas.
- Vapours are heavier than air. They can spread along the ground and form mixtures that are explosive with air.
- Prevent the formation of flammable or explosive concentrations in air and avoid vapor concentrations higher than the occupational exposure limits.
- Prevent the accumulation of electrostatic charges with connections to earth.
- The mixture can become electrostatically charged : always earth during decanting operations. Wear antistatic shoes and clothing and floors should be electrically conductive.
- Use the mixture in premises free of naked flames or other sources of ignition and ensure that electrical equipment is suitably protected.
- Keep packages tightly closed and away from sources of heat, sparks and naked flames.
- Do not use tools which may produce sparks. Do not smoke.
- Prevent access by unauthorised personnel.

Recommended equipment and procedures :

- For personal protection, see section 8.
- Observe precautions stated on label and also industrial safety regulations.
- Avoid inhaling vapors.
- Avoid inhaling vapors. Carry out any industrial operation which may give rise to this in a sealed apparatus.
- Provide vapor extraction at the emission source and also general ventilation of the premises.
- Also provide breathing apparatus for certain short tasks of an exceptional nature and for emergency interventions.
- In all cases, recover emissions at source.
- Avoid skin and eye contact with this mixture.
- Packages which have been opened must be reclosed carefully and stored in an upright position.

Prohibited equipment and procedures :

- No smoking, eating or drinking in areas where the mixture is used.

7.2. Conditions for safe storage, including any incompatibilities

No data available.

Storage

- Keep out of reach of children.
- Keep the container tightly closed in a dry, well-ventilated place.
- Keep away from all sources of ignition - do not smoke.
- Keep well away from all sources of ignition, heat and direct sunlight.
- Avoid accumulation of electrostatic charges.
- The floor must be impermeable and form a collecting basin so that, in the event of an accidental spillage, the liquid cannot spread beyond this area.

Packaging

- Always keep in packaging made of an identical material to the original.

7.3. Specific end use(s)

No data available.

SECTION 8 : EXPOSURE CONTROLS/PERSONAL PROTECTION

8.1. Control parameters

Occupational exposure limits :

- ACGIH TLV (American Conference of Governmental Industrial Hygienists, Threshold Limit Values, 2010) :

CAS	TWA :	STEL :	Ceiling :	Definition :	Criteria :
1344-28-1	10 mg/m3	-	-	-	-

CHROM ALU 200 ML- 800675 - A16245

- France (INRS - ED984 :2012) :

CAS	VME-ppm :	VME-mg/m3 :	VLE-ppm :	VLE-mg/m3 :	Notes :	TMP No :
1344-28-1	-	10	-	-	-	-

- UK / WEL (Workplace exposure limits, EH40/2005, 2007) :

CAS	TWA :	STEL :	Ceiling :	Definition :	Criteria :
1344-28-1	4 mg/m3				

8.2. Exposure controls

Personal protection measures, such as personal protective equipment

Use personal protective equipment that is clean and has been properly maintained.

Store personal protective equipment in a clean place, away from the work area.

Never eat, drink or smoke during use. Remove and wash contaminated clothing before re-using. Ensure that there is adequate ventilation, especially in confined areas.

- Eye / face protection

Avoid contact with eyes.

Use eye protectors designed to protect against liquid splashes

Before handling, wear safety goggles with protective sides accordance with standard EN166.

In the event of high danger, protect the face with a face shield.

Prescription glasses are not considered as protection.

Individuals wearing contact lenses should wear prescription glasses during work where they may be exposed to irritant vapours.

Provide eyewash stations in facilities where the product is handled constantly.

- Hand protection

Use suitable protective gloves that are resistant to chemical agents in accordance with standard EN374.

Gloves must be selected according to the application and duration of use at the workstation.

Protective gloves need to be selected according to their suitability for the workstation in question : other chemical products that may be handled, necessary physical protections (cutting, pricking, heat protection), level of dexterity required.

Type of gloves recommended :

- Nitrile rubber (butadiene-acrylonitrile copolymer rubber (NBR))

- PVA (Polyvinyl alcohol)

Recommended properties :

- Impervious gloves in accordance with standard EN374

- Body protection

Avoid skin contact.

Wear suitable protective clothing.

Suitable type of protective clothing :

In the event of substantial spatter, wear liquid-tight protective clothing against chemical risks (type 3) in accordance with EN14605 to prevent skin contact.

In the event of a risk of splashing, wear protective clothing against chemical risks (type 6) in accordance with EN13034 to prevent skin contact.

Work clothing worn by personnel shall be laundered regularly.

After contact with the product, all parts of the body that have been soiled must be washed.

- Respiratory protection

Avoid breathing vapours.

If the ventilation is insufficient, wear appropriate breathing apparatus.

When workers are confronted with concentrations that are above occupational exposure limits, they must wear a suitable, approved, respiratory protection device.

Anti-gas and vapour filter(s) (Combined filters) in accordance with standard EN14387 :

- A1 (Brown)

Types, classes and filters for respiratory protection above are recommended in case of confrontation at concentrations higher than the exposure limits specified under 8.1. (Control parameters) .They should be adjusted according to actual conditions. they may not be necessary if the product is used outdoors or in a well ventilated area.

>SECTION 9 : PHYSICAL AND CHEMICAL PROPERTIES

9.1. Information on basic physical and chemical properties

General information :

Physical state :

Fluid liquid.

CHROM ALU 200 ML- 800675 - A16245

> Important health, safety and environmental information

pH :	Not relevant.
Boiling point/boiling range :	Not specified.
Flash Point Interval :	23°C <= FP <= 55°C
Vapour pressure (50°C) :	Below 110 kPa (1.10 bar).
Density :	< 1
Water solubility :	Dilutable.
Melting point/melting range :	Not specified.
Self-ignition temperature :	Not specified.
Decomposition point/decomposition range :	Not specified.

9.2. Other information

No data available.

SECTION 10 : STABILITY AND REACTIVITY

10.1. Reactivity

No data available.

10.2. Chemical stability

This mixture is stable under the recommended handling and storage conditions in section 7.

10.3. Possibility of hazardous reactions

When exposed to high temperatures, the mixture can release hazardous decomposition products, such as carbon monoxide and dioxide, fumes and nitrogen oxide.

10.4. Conditions to avoid

Any apparatus likely to produce a flame or to have a metallic surface at high temperature (burners, electric arcs, furnaces etc.) must not be allowed on the premises.

Avoid :

- accumulation of electrostatic charges.
- heating
- heat
- flames and hot surfaces

10.5. Incompatible materials

10.6. Hazardous decomposition products

The thermal decomposition may release/form :

- carbon monoxide (CO)
- carbon dioxide (CO₂)

SECTION 11 : TOXICOLOGICAL INFORMATION

11.1. Information on toxicological effects

Exposure to vapours from solvents in the mixture in excess of the stated occupational exposure limit may result in adverse health effects such as mucous membrane and respiratory system irritation and adverse effects on kidney, liver and central nervous system.

Symptoms produced will include headaches, numbness, dizziness, fatigue, muscular asthenia and, in extreme cases, loss of consciousness.

May cause irreversible damage to the skin; namely inflammation of the skin or the formation of erythema and eschar or oedema following exposure up to four hours.

Repeated or prolonged contact with the mixture may cause removal of natural oil from the skin resulting in non-allergic contact dermatitis and absorption through the skin.

May have reversible effects on the eyes, such as eye irritation which is totally reversible by the end of observation at 21 days.

Splashes in the eyes may cause irritation and reversible damage

Narcotic effects may occur, such as drowsiness, narcosis, decreased alertness, loss of reflexes, lack of coordination or dizziness.

Effects may also occur in the form of violent headaches or nausea, judgement disorder, giddiness, irritability, fatigue or memory disturbance.

11.1.1. Substances

No toxicological data available for the substances.

11.1.2. Mixture

No toxicological data available for the mixture.

CHROM ALU 200 ML- 800675 - A16245

SECTION 12 : ECOLOGICAL INFORMATION

12.1. Toxicity

12.1.2. Mixtures

No aquatic toxicity data available for the mixture.

12.2. Persistence and degradability

No data available.

12.3. Bioaccumulative potential

No data available.

12.4. Mobility in soil

No data available.

12.5. Results of PBT and vPvB assessment

No data available.

12.6. Other adverse effects

No data available.

SECTION 13 : DISPOSAL CONSIDERATIONS

Proper waste management of the mixture and/or its container must be determined in accordance with Directive 2008/98/EC.

13.1. Waste treatment methods

Do not pour into drains or waterways.

Waste :

Waste management is carried out without endangering human health, without harming the environment and, in particular without risk to water, air, soil, plants or animals.

Recycle or dispose of waste in compliance with current legislation, preferably via a certified collector or company.

Do not contaminate the ground or water with waste, do not dispose of waste into the environment.

Soiled packaging :

Empty container completely. Keep label(s) on container.

Give to a certified disposal contractor.

SECTION 14 : TRANSPORT INFORMATION

Transport product in compliance with provisions of the ADR for road, RID for rail, IMDG for sea and ICAO/IATA for air transport (ADR 2017 - IMDG 2016 - ICAO/IATA 2017).

14.1. UN number

1993

14.2. UN proper shipping name

UN1993=FLAMMABLE LIQUID, N.O.S.

(hydrocarbons, c9-c11, n-alkanes, isoalkanes, cyclics, <2% aromatics)

14.3. Transport hazard class(es)

- Classification :



3

14.4. Packing group

III

14.5. Environmental hazards

-

14.6. Special precautions for user

ADR/RID	Class	Code	Pack gr.	Label	Ident.	LQ	Provis.	EQ	Cat.	Tunnel
	3	F1	III	3	30	5 L	274 601	E1	3	D/E

If Q <450l, see 2.2.3.1.5.1.

IMDG	Class	2°Label	Pack gr.	LQ	EMS	Provis.	EQ
------	-------	---------	----------	----	-----	---------	----

CHROM ALU 200 ML- 800675 - A16245

	3	-	III	5 L	F-E,S-E	223 274 955	E1
--	---	---	-----	-----	---------	-------------	----

If Q <30l, see 2.3.2.5.

IATA	Class	2°Label	Pack gr.	Passager	Passager	Cargo	Cargo	note	EQ
	3	-	III	355	60 L	366	220 L	A3	E1
	3	-	III	Y344	10 L	-	-	A3	E1

For limited quantities, see part 2.7 of the OACI/IATA and chapter 3.4 of the ADR and IMDG.

For excepted quantities, see part 2.6 of the OACI/IATA and chapter 3.5 of the ADR and IMDG.

14.7. Transport in bulk according to Annex II of Marpol and the IBC Code

No data available.

>SECTION 15 : REGULATORY INFORMATION

15.1. Safety, health and environmental regulations/legislation specific for the substance or mixture

> - Classification and labelling information included in section 2:

The following regulations have been used:

- EU Regulation No. 1272/2008 amended by EU Regulation No. 2016/1179. (ATP 9)

- Container information:

No data available.

- Particular provisions :

No data available.

15.2. Chemical safety assessment

No data available.

SECTION 16 : OTHER INFORMATION

Since the user's working conditions are not known by us, the information supplied on this safety data sheet is based on our current level of knowledge and on national and community regulations.

The mixture must not be used for other uses than those specified in section 1 without having first obtained written handling instructions.

It is at all times the responsibility of the user to take all necessary measures to comply with legal requirements and local regulations.

The information in this safety data sheet must be regarded as a description of the safety requirements relating to the mixture and not as a guarantee of the properties thereof.

Wording of the phrases mentioned in section 3 :

H226	Flammable liquid and vapour.
H304	May be fatal if swallowed and enters airways.
H314	Causes severe skin burns and eye damage.
H335	May cause respiratory irritation.
H336	May cause drowsiness or dizziness.
EUH066	Repeated exposure may cause skin dryness or cracking.

Abbreviations :

ADR : European agreement concerning the international carriage of dangerous goods by Road.

IMDG : International Maritime Dangerous Goods.

IATA : International Air Transport Association.

ICAO : International Civil Aviation Organisation

RID : Regulations concerning the International carriage of Dangerous goods by rail.

WGK : Wassergefährdungsklasse (Water Hazard Class).

GHS02 : Flame

GHS07 : Exclamation mark

PBT: Persistent, bioaccumulable and toxic.

vPvB : Very persistent, very bioaccumulable.

SVHC : Substances of very high concern.

CHROM'ALU



- Active microbeads cream
- Cleans and renovates all metal parts (steel, chrome, aluminum, etc....)
- Removes rust and oxidation
- Polishes
- Easy application



200 ML

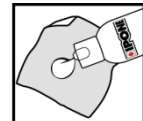

Additional



NEW