

LEATHER CREAM 100ML- 800679 - A18245



SAFETY DATA SHEET

(REACH regulation (EC) n° 1907/2006 - n° 2015/830)

>SECTION 1 : IDENTIFICATION OF THE SUBSTANCE/MIXTURE AND OF THE COMPANY/UNDERTAKING

1.1. Product identifier

Product name : LEATHER CREAM 100ML- 800679

Product code : A18245.

> 1.2. Relevant identified uses of the substance or mixture and uses advised against

Detergent

1.3. Details of the supplier of the safety data sheet

Registered company name : IPONE.

Address : La Meunière .13480.CABRIES .FRANCE.

Telephone : +33 (0)4 42 94 05 65. Fax : +33 (0)4 42 94 05 66.

info@ipone.fr

1.4. Emergency telephone number : +33 (0)1 45 42 59 59.

Association/Organisation : INRS / ORFILA <http://www.centres-antipoison.net>.

>SECTION 2 : HAZARDS IDENTIFICATION

2.1. Classification of the substance or mixture

In compliance with EC regulation No. 1272/2008 and its amendments.

May produce an allergic reaction (EUH208).

This mixture does not present a physical hazard. Refer to the recommendations regarding the other products present on the site.

This mixture does not present an environmental hazard. No known or foreseeable environmental damage under standard conditions of use.

2.2. Label elements

Detergent mixture (see section 15).

In compliance with EC regulation No. 1272/2008 and its amendments.

Additional labeling :

EUH208 Contains 1,2-BENZISOTHIAZOL-3(2H)-ONE. May produce an allergic reaction.

Precautionary statements - General :

P101 If medical advice is needed, have product container or label at hand.

P102 Keep out of reach of children.

Other information :

keep only in well ventilated zones. Do not use for a usage other one than the one for which the product is intended.

> 2.3. Other hazards

REACH SVHC < 0.1%

Considering the information communicated by our suppliers, according to the article 33 of the REACH, the mixture contains, in the date of revision of the FDS, less than 0.1 % m/m of ' Substances extrêmement worrysome ' (SVHC) published by the European Agency of Chemicals (ECHA) according to the article 57 of the REACH: <http://echa.europa.eu/fr/candidate-liste-table>

SECTION 3 : COMPOSITION/INFORMATION ON INGREDIENTS

3.2. Mixtures

Composition :

Identification	(EC) 1272/2008	Note	%
INDEX: 918_481_9 CAS: 918_481_9 EC: 918-481-9 REACH: 01-2119457273-39	GHS08 Dgr Asp. Tox. 1, H304 EUH:066		2.5 <= x % < 10
HYDROCARBURES C10 C13 N-ALCANES, ISOALCANES, CYCLIQUES, <2% AROMATIQUES			

LEATHER CREAM 100ML- 800679 - A18245

INDEX: 613-088-00-6 CAS: 2634-33-5 EC: 220-120-9 1,2-BENZISOTHIAZOL-3(2H)-ONE	GHS05, GHS07, GHS09 Dgr Acute Tox. 4, H302 Skin Irrit. 2, H315 Eye Dam. 1, H318 Skin Sens. 1, H317 Aquatic Acute 1, H400 M Acute = 1		0 <= x % < 1
--	---	--	--------------

SECTION 4 : FIRST AID MEASURES

As a general rule, in case of doubt or if symptoms persist, always call a doctor.
NEVER induce swallowing by an unconscious person.

4.1. Description of first aid measures

In the event of exposure by inhalation :

In the event of an allergic reaction, seek medical attention.
In case of massive inhalation transport the patient outdoors and keep him for the warmth and for the rest.

In the event of splashes or contact with eyes :

Wash thoroughly with fresh, clean water for 15 minutes holding the eyelids open.
Send the subject at an ophthalmologist, in particular if it appears a redness, a pain or a visual embarrassment.

In the event of splashes or contact with skin :

In the event of an allergic reaction, seek medical attention.
Remove contaminated clothing and wash skin thoroughly with soap and water or a recognized cleaner.
DO NOT use solvents or thinners.

In the event of swallowing :

In the event of swallowing, if the quantity is small (no more than one mouthful), rinse the mouth with water and consult a doctor.
Keep the person exposed at rest. Do not force vomiting.
Seek medical attention, showing the label.
If swallowed accidentally, call a doctor to ascertain whether observation and hospital care will be necessary. Show the label.

4.2. Most important symptoms and effects, both acute and delayed

No data available.

4.3. Indication of any immediate medical attention and special treatment needed

No data available.

SECTION 5 : FIREFIGHTING MEASURES

Non-flammable.

5.1. Extinguishing media

Suitable methods of extinction

In the event of a fire, use :
- sprayed water or water mist
- foam
- multipurpose ABC powder
- BC powder
- carbon dioxide (CO₂)

Unsuitable methods of extinction

In the event of a fire, do not use :
- water jet

5.2. Special hazards arising from the substance or mixture

A fire will often produce a thick black smoke. Exposure to decomposition products may be hazardous to health.
Do not breathe in smoke.
In the event of a fire, the following may be formed :
- carbon monoxide (CO)
- carbon dioxide (CO₂)

LEATHER CREAM 100ML- 800679 - A18245

5.3. Advice for firefighters

Due to the toxicity of the gas emitted on thermal decomposition of the products, fire-fighting personnel are to be equipped with autonomous insulating breathing apparatus.

SECTION 6 : ACCIDENTAL RELEASE MEASURES

6.1. Personal precautions, protective equipment and emergency procedures

Consult the safety measures listed under headings 7 and 8.

For first aid worker

First aid workers will be equipped with suitable personal protective equipment (See section 8).

6.2. Environmental precautions

Contain and control the leaks or spills with non-combustible absorbent materials such as sand, earth, vermiculite, diatomaceous earth in drums for waste disposal.

Prevent any material from entering drains or waterways.

6.3. Methods and material for containment and cleaning up

Clean preferably with a detergent, do not use solvents.

6.4. Reference to other sections

No data available.

SECTION 7 : HANDLING AND STORAGE

Requirements relating to storage premises apply to all facilities where the mixture is handled.

7.1. Precautions for safe handling

Always wash hands after handling.

Remove and wash contaminated clothing before re-using.

Ensure that there is adequate ventilation, especially in confined areas.

Fire prevention :

Handle in well-ventilated areas.

Prevent access by unauthorised personnel.

Recommended equipment and procedures :

For personal protection, see section 8.

Observe precautions stated on label and also industrial safety regulations.

Packages which have been opened must be reclosed carefully and stored in an upright position.

Prohibited equipment and procedures :

No smoking, eating or drinking in areas where the mixture is used.

7.2. Conditions for safe storage, including any incompatibilities

No data available.

Storage

Keep out of reach of children.

Keep the container tightly closed in a dry, well-ventilated place.

The floor must be impermeable and form a collecting basin so that, in the event of an accidental spillage, the liquid cannot spread beyond this area.

Packaging

Always keep in packaging made of an identical material to the original.

7.3. Specific end use(s)

No data available.

>SECTION 8 : EXPOSURE CONTROLS/PERSONAL PROTECTION

8.1. Control parameters

No data available.

8.2. Exposure controls

Personal protection measures, such as personal protective equipment

Use personal protective equipment that is clean and has been properly maintained.

Store personal protective equipment in a clean place, away from the work area.

Never eat, drink or smoke during use. Remove and wash contaminated clothing before re-using. Ensure that there is adequate ventilation, especially in confined areas.

LEATHER CREAM 100ML- 800679 - A18245

> - Eye / face protection

Avoid contact with eyes.
Use eye protectors designed to protect against liquid splashes
Before handling, wear safety goggles in accordance with standard EN166.
In case of risk of splashing, wear safety goggles to standard EN166

- Hand protection

Wear suitable protective gloves in the event of prolonged or repeated skin contact.
Use suitable protective gloves that are resistant to chemical agents in accordance with standard EN374.
Gloves must be selected according to the application and duration of use at the workstation.
Protective gloves need to be selected according to their suitability for the workstation in question : other chemical products that may be handled, necessary physical protections (cutting, pricking, heat protection), level of dexterity required.

Type of gloves recommended :

- Nitrile rubber (butadiene-acrylonitrile copolymer rubber (NBR))
- PVA (Polyvinyl alcohol)

Recommended properties :

- Impervious gloves in accordance with standard EN374

- Body protection

Work clothing worn by personnel shall be laundered regularly.
After contact with the product, all parts of the body that have been soiled must be washed.

>SECTION 9 : PHYSICAL AND CHEMICAL PROPERTIES

9.1. Information on basic physical and chemical properties

General information :

Physical state : Fluid liquid.

> Important health, safety and environmental information

pH :	Not stated. Slightly basic.
Boiling point/boiling range :	Not specified.
Flash Point Interval :	60°C < FP <= 93°C
Vapour pressure (50°C) :	Below 110 kPa (1.10 bar).
Density :	< 1
Water solubility :	Dilutable.
Melting point/melting range :	Not specified.
Self-ignition temperature :	Not specified.
Decomposition point/decomposition range :	Not specified.

9.2. Other information

No data available.

SECTION 10 : STABILITY AND REACTIVITY

10.1. Reactivity

No data available.

10.2. Chemical stability

This mixture is stable under the recommended handling and storage conditions in section 7.

10.3. Possibility of hazardous reactions

When exposed to high temperatures, the mixture can release hazardous decomposition products, such as carbon monoxide and dioxide, fumes and nitrogen oxide.

10.4. Conditions to avoid

Avoid :
- frost

10.5. Incompatible materials

10.6. Hazardous decomposition products

The thermal decomposition may release/form :
- carbon monoxide (CO)
- carbon dioxide (CO2)

LEATHER CREAM 100ML- 800679 - A18245

SECTION 11 : TOXICOLOGICAL INFORMATION

11.1. Information on toxicological effects

Splashes in the eyes may cause irritation and reversible damage

11.1.1. Substances

No toxicological data available for the substances.

11.1.2. Mixture

Respiratory or skin sensitisation :

Contains at least one sensitising substance. May cause an allergic reaction.

SECTION 12 : ECOLOGICAL INFORMATION

12.1. Toxicity

12.1.2. Mixtures

No aquatic toxicity data available for the mixture.

12.2. Persistence and degradability

No data available.

12.3. Bioaccumulative potential

No data available.

12.4. Mobility in soil

No data available.

12.5. Results of PBT and vPvB assessment

No data available.

12.6. Other adverse effects

No data available.

SECTION 13 : DISPOSAL CONSIDERATIONS

Proper waste management of the mixture and/or its container must be determined in accordance with Directive 2008/98/EC.

13.1. Waste treatment methods

Do not pour into drains or waterways.

Waste :

Waste management is carried out without endangering human health, without harming the environment and, in particular without risk to water, air, soil, plants or animals.

Recycle or dispose of waste in compliance with current legislation, preferably via a certified collector or company.

Do not contaminate the ground or water with waste, do not dispose of waste into the environment.

Soiled packaging :

Empty container completely. Keep label(s) on container.

Give to a certified disposal contractor.

>SECTION 14 : TRANSPORT INFORMATION

Exempt from transport classification and labelling.

> 14.1. UN number

-

> 14.2. UN proper shipping name

-

> 14.3. Transport hazard class(es)

-

> 14.4. Packing group

-

> 14.5. Environmental hazards

-

LEATHER CREAM 100ML- 800679 - A18245

> **14.6. Special precautions for user**

-

> **SECTION 15 : REGULATORY INFORMATION**

15.1. Safety, health and environmental regulations/legislation specific for the substance or mixture

> **- Classification and labelling information included in section 2:**

The following regulations have been used:

- EU Regulation No. 1272/2008 amended by EU Regulation No. 2016/1179. (ATP 9)

- Container information:

No data available.

- Particular provisions :

No data available.

- Labelling for detergents (EC Regulation No. 648/2004,907/2006) :

- less than 5 % : nonionic surfactants

- 5 % or over but less than 15 % : aliphatic hydrocarbons

- perfumes

- preservation agents

benzisothiazolinone

15.2. Chemical safety assessment

No data available.

SECTION 16 : OTHER INFORMATION

Since the user's working conditions are not known by us, the information supplied on this safety data sheet is based on our current level of knowledge and on national and community regulations.

The mixture must not be used for other uses than those specified in section 1 without having first obtained written handling instructions.

It is at all times the responsibility of the user to take all necessary measures to comply with legal requirements and local regulations.

The information in this safety data sheet must be regarded as a description of the safety requirements relating to the mixture and not as a guarantee of the properties thereof.

Wording of the phrases mentioned in section 3 :

H302	Harmful if swallowed.
H304	May be fatal if swallowed and enters airways.
H315	Causes skin irritation.
H317	May cause an allergic skin reaction.
H318	Causes serious eye damage.
H400	Very toxic to aquatic life.
EUH066	Repeated exposure may cause skin dryness or cracking.

Abbreviations :

ADR : European agreement concerning the international carriage of dangerous goods by Road.

IMDG : International Maritime Dangerous Goods.

IATA : International Air Transport Association.

ICAO : International Civil Aviation Organisation

RID : Regulations concerning the International carriage of Dangerous goods by rail.

WGK : Wassergefährdungsklasse (Water Hazard Class).

PBT: Persistent, bioaccumulable and toxic.

vPvB : Very persistent, very bioaccumulable.

SVHC : Substances of very high concern.

LEATHER CREAM



- Nourishing balm for leather
- Cleans
- Leather caring and protection
- Removes insects
- Ideal for leather jackets, boots, gloves
- Convenient size

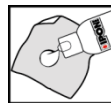

Additional



NEW