

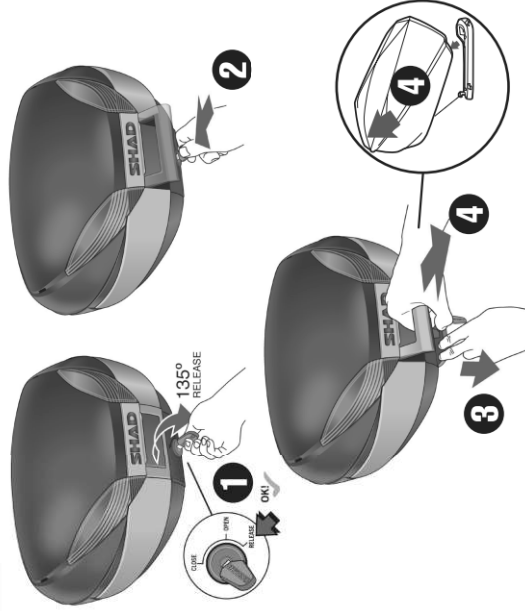

Release



Accessories (Optional)



Backrest
Ref. D0R14800

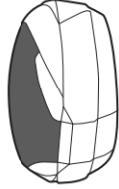

Colour cover
Ref. D1B48EXX



Brake light
Ref. D0B29KL

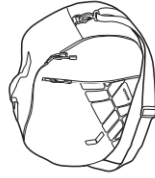

Inner bag
Ref. X01B00

Other Shad Products



Soft Bags



Communication

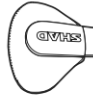

Backrests



Comfort Seats

SHAD

INSTRUCTION MANUAL

SH48



! IMPORTANT WARRANTY INFO: www.shad.es

SHAD
WWW.SHAD.ES

Rol iud. Gen. Magarola
C/IBRAULET DEL VALLES
BARCELONA (SPAIN)

España 0034 935 795 800
Teléfono 0034 935 795 801
Fax 0034 935 795 805
www.shad.es

Code: 500922 - Edition: 6 - Date: 02-01-2019

SH48

INSPIRED IN BARCELONA®
WWW.SHAD.ES

Open

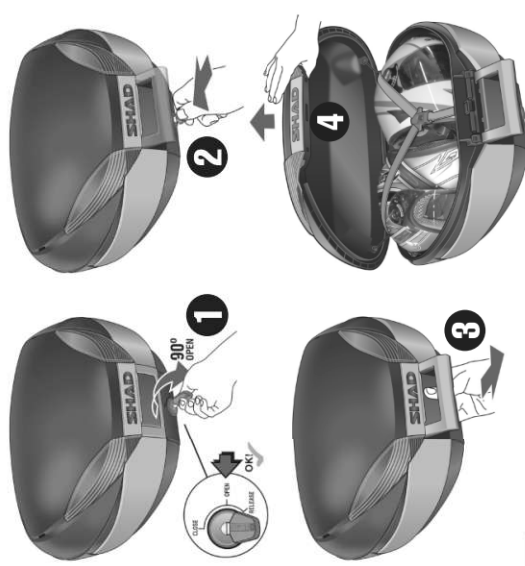

Close

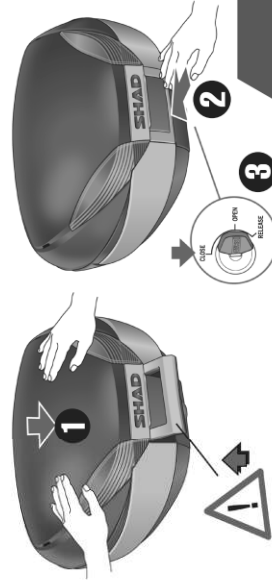

Top case support assembly

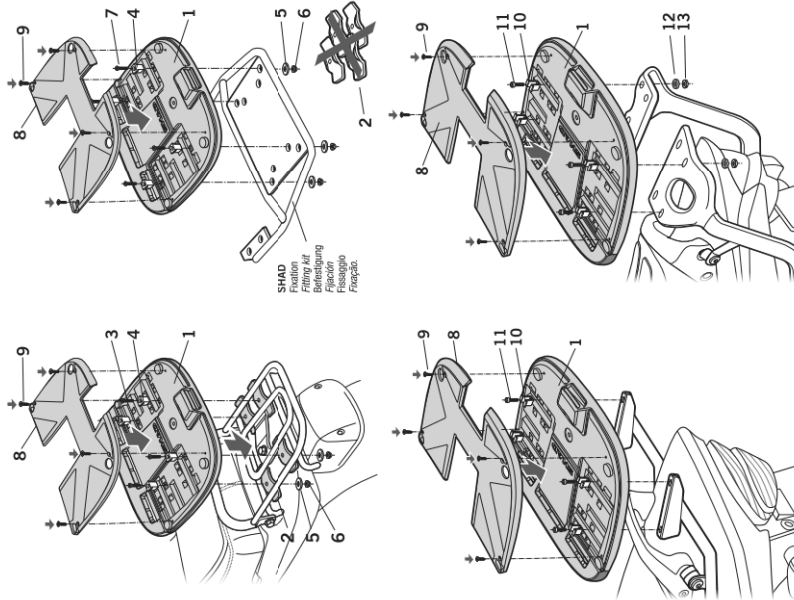

Number	Reference	Quantity
1	20154 (Support piece)	1
2	20109 (Buckle)	4
3	30414 (Screw M6x10 DIN 955)	4
4	20073/32 (Plastic cord)	4
5	30300 (85 Washer 16 M6 DIN 125 A)	4
6	30202 (M6 Nut M6 DIN 955)	4
7	30459 (Screw M6x30 DIN 955)	4
8	20163 (One support piece)	1
9	30427 (Screw 13x13 DIN 7992)	4
10	20150 (Metal piece)	4
11	304074 (Screw M6x20 DIN 912)**	4
12	30320 (85 Washer 16 M6 DIN 125 A)**	4
13	300254 (Nut M6 DIN 955)**	4

- (B) **Note:** Consult accessories with your distributor.
- (*) It can only be used on the Top or Full master.
- (F) **Attention:** Consultez les accessoires avec votre distributeur.
- (*) Inclus dans le support spécifique.
- (*) Includi dans il supporto specifico.
- (D) **Anmerkung:** Ausrüsteter zu dem Zubehör beitragen.
- (*) Wird nur im Top und Full Master verwendet.
- (*) In specificazioni relativi emittente.
- (*) Solo se utilizzati con il supporto specifico.
- (*) Solo se utilizados con il suo rivenditore.
- (*) Solo se utilizados con il Top e Full Master.
- (*) Solo se utilizados con el soporte específico.
- (*) Apenas se utilizó para o Top e Full Master.
- (*) Includiti nel supporto específico.

FAQ's and more information



One key  = 
For three cases

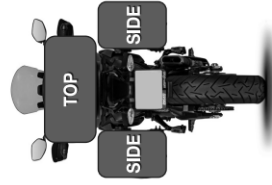

SH48