



HEATED GRIPS 4-LEVEL CONTROL

TABLE OF CONTENTS

SEC.1	WARNINGS	-----	Page1
SEC.2	COMPONENTS	-----	Page1
SEC.3	WIRING DIAGRAM	-----	Page2
SEC.4	INSTALLATION	-----	Page2-4
SEC.5	OPERATION	-----	Page4

SEC.1 WARNINGS

(A) General

- Designed for DC12V power source, will NOT work with DC6V.
- A weak or flat battery will NOT provide enough current to work properly.
- Do not cut, bend, twist or hit the grips.

(B) Installation

- Do NOT connect to a wire that connects to ECU.
- Do NOT connect to a wire that connects to immobilizer.
- Do NOT connect to a wire that connects to headlight/ winker/ horn.
- Do NOT connect directly to battery.
- Do NOT cut any wire to connect.

(C) Operation

- Do NOT hold grips with bare hands while it's operating.
- Need to always wear motorcycle gloves.
- To save battery power, use the heated grips only when the engine is running.

SEC.2 COMPONENTS

#	DESCRIPTION	Q' TY	#	DESCRIPTION	Q' TY
①	Left Grip	1	⑧	Rubber Band	1
②	Right Grip	1	⑨	Insulation Displacement Connector	2
③	Heat Control Unit	1			
④	Mounting Bracket (upper)	1	⑩	Double-sided Tape	1
⑤	Mounting Bracket (lower)	1	⑪	Cable Tie	2
⑥	Hex. Head Screw	2	⑫	End Cap	2
⑦	Spring Washer	2	⑬	Instruction Manual	1

SEC.3 WIRING DIAGRAM

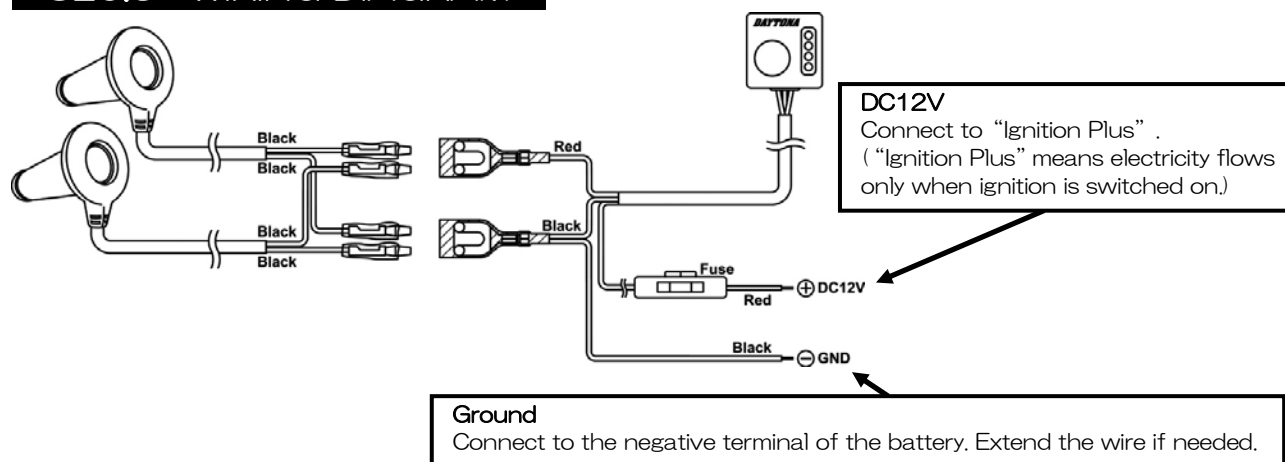

OEM Wiring Color List

Manufacturer	Plus (Red wire in the kit)	Minus (Black wire in the kit)
HONDA	Red/ Black, or Black	Green
YAMAHA	Brown, or Brown/ Blue	Black
SUZUKI	Orange	Black/ White
KAWASAKI	Brown	Black/ Yellow

*** OEM Wiring Color List is only for your reference. Wiring color might be different between the model, country, or model year. Please check with the vehicle owner's manual or voltmeter.

SEC.4 INSTALLATION

Before installing the heated grips, it is recommended to check if they are functioning correctly. To carry out this pre-installation check, attach Left Grip wires to the positive post of the vehicle's battery and the other wire to the negative post. Wait for 1-2 minutes until it is clear that the grip is warm and functioning correctly. Repeat the process for Right Grip. If in doubt about the functionality of either grip, contact your dealer before installing.

1. Disconnect the negative terminal of the vehicle's battery and insulate it with insulating tape.



2. Remove the existing handlebar grips.
3. Remove any residual glue on the handlebar or throttle sleeve before the Heated Grips are attached. If present, remove any anti-slip ribs on throttle sleeve by scraping them off with a knife so that the Heated Grip slides easily onto the throttle sleeve.
4. Degrease and clean inside of the Heated Grips and also the surface of the handlebar and throttle sleeve.
5. Find suitable wires and connect the Red & Black wires from the Heat Control Unit.

-
- 1] Connect the Red wire from the Heat Control Unit to DC12V wiring using the insulation displacement connector provided.

Tips for DC12V wiring:

We recommend you to use "Ignition Plus" wiring comes out directly from ignition key cylinder.

- Use voltmeter to find which wire is "Ignition Plus" .
- This wire might be too thick to connect with insulation displacement connector. In that case, follow the wire until you find out appropriate wire thickness to connect.

⚠ CAUTION

Do NOT connect directly to battery.
 Do NOT cut any wire to connect.
 Do NOT connect to a wire that connects to immobilizer.
 Do NOT connect to a wire that connects to headlight/winker/horn.
 Do NOT connect to a wire that connects to ECU.

Some fuel-injected vehicles control the maximum current on some circuits.
 Be sure to connect the red wire from the Heated Grip Control Unit to a circuit that has no such restriction. If in doubt consult your dealer.



Do NOT connect to these wires!

Example: HONDA CB1300SF

Find a Red/Black wire from Ignition.



② Connect the Black wire from the Heat Control Unit to Ground wiring.

Tips for Ground wiring:

Negative terminal of the battery is recommended. However, if you wish to connect it to vehicle's frame, ensure that any paint or corrosion is removed using emery paper to ensure a good electrical connection..

6. Degrease inside of Left grip, Right grip, and handlebar. Then slide Left grip onto handlebar. Right grip should slide onto throttle sleeve.

Use a heat resistant glue (two liquid type epoxy glue is recommended).

After installing Right grip, ensure the wire not interfere the acceleration movement. Ignoring this procedure may cause serious injury while riding.

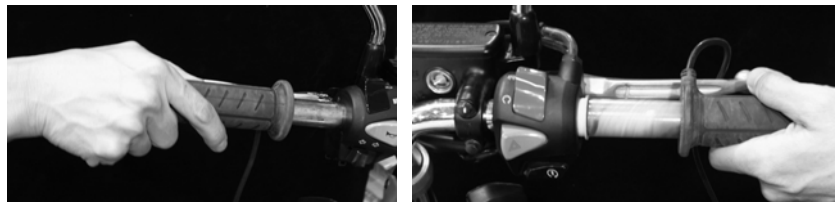

7. See the wiring diagram on SEC.3 (page 1), and then connect the remaining heated grip wires accordingly using insulation displacement connectors.



8. Locate a suitable position for the Heat Control Unit. The Heat Control Unit can be attached to any flat area or the handlebar by using the double-sided tape or bracket provided.

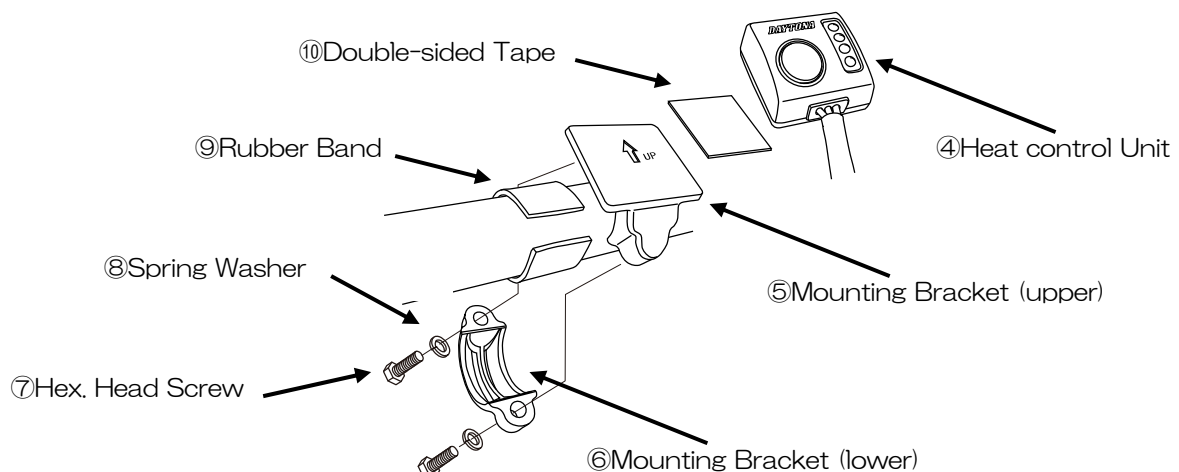

9. After installation, move the handlebar to the left and right in order to ensure nothing obstructs the steering movement.
10. Re-connect the negative terminal to the vehicle's battery and tighten it firmly.

SEC.5 OPERATION

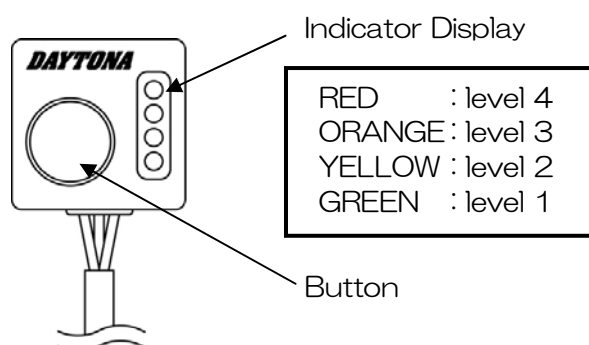

To turn the power ON:

Hold down the button for around 3 seconds.

Changing the Heat Level:

Press the button to change the heat level.

Level will change every time pressing the button.

Ex.) Level 1⇒2⇒3⇒4⇒1

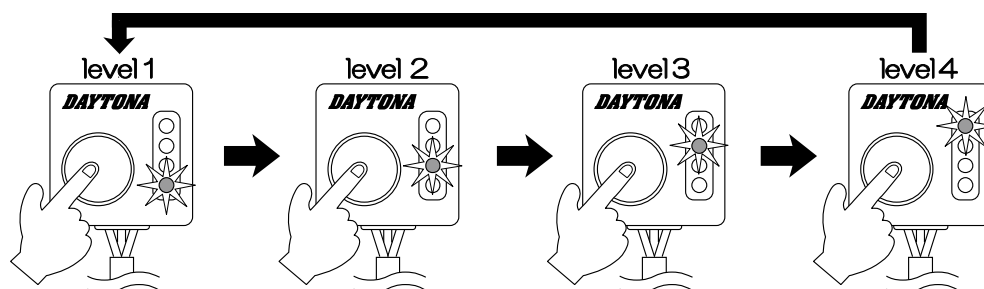

To turn the power OFF:

Hold down the button for around 3 seconds.

Memory Function:

The heat level of the previous session is memorized and recalled at the next use.

Quick Heating:

Quick heating function always works for 4 minutes from the start.

During the quick heating, the LED of memorized level flashes.

Quick heating can be cancelled by pressing the button.